

**PROJECT NO. 38-CW-1(SG)**  
**LAUDERDALE COUNTY BID NO. 3843**  
**SITE GRADING AT THE 1-20/59 INDUSTRIAL PARK**  
**LAUDERDALE COUNTY**

**ADDENDUM NO. 4**

TO: ALL BIDDERS ON THE ABOVE REFERENCED PROJECT

FROM: Terrell W. Temple, P.E.

DATE: January 4, 2019

SUBJECT: ADDENDUM NO. 4

**I. Clarification – Section S-102.08 – Proposal Guarantee**

State law requires a proposal guarantee in the form of a certified check, cashier's check or bid bond. The guarantee should be payable to the Lauderdale County Board of Supervisors in an amount not less than 5% of the total amount of the bid proposal. It is to be signed or counter signed by a Mississippi agent or qualified non-resident agent and the bidder.

**II. Clarification - Quality Control for Earthwork Construction**

Quality Control for earthwork construction on the site is to be provided at no cost to the contractor.

**III. Clarification - Burning on Site**

As noted in Addendum No. 3, burning on site is allowable. However, any material which cannot be burned shall be wasted off site.

**IV. Clarification – Section S-109-08, Changes in Material Cost**

Section S-109-08, Changes in Material Cost, will not apply on this project.

**V. Clarification – Stormwater General NPDES Permit**

Lauderdale County has received a Stormwater General NPDES Permit (Permit No. MSR107869) for this site. This general permit will be assigned to the contractor for maintenance of the SWPPP. This is a general permit with no limits as long as other requirements of the standard permits are achieved.

**VI. Clarification – Working Hours**

There is no restrictions on working hours for the contractor. However, 24 hours advance notice shall be provided as to when construction will be performed.

**VII. Clarification – Paragraph S-201.03.1, Clearing and Grubbing**

All stumps in fill areas shall be removed prior to backfill.

**VIII. Clarification – Existing Gas Line**

The existing gas line which needs to be relocated as a part of this project provides emergency service to a single customer. It is not required that a hot tap be provided. The gas line contractor shall provide 5 working day notice to the engineer as to when connections need to be made. The engineer will coordinate with Atmos and the customer to verify the proposed time meets their requirements. A conventional tap can then be provided.

**IX. Clarification – Sheet C6.1, Site Details**

On Sheet C6.1, Site Details, delete note regarding Sweet Gum Bottom closure. Instead, add the following:

Sweet Gum Bottom Road, from North of I-20/59 to Highway 11/80, has been closed by city ordinance. However, the closure does not become effective until an alternate access is provided. The alternate access will extend adjacent to and parallel to I-29/59 from the existing Sweet Gum Bottom Road near the elevated water storage tank west, south of the existing NFI Distribution Center, to Handy Boulevard. For bidding purposes and, based upon current city plans, the detour road is to be completed no later than April 15, 2019. At that time, the roadway can be permanently closed.

It is possible the successful bidder may be able to work on either side of Sweet Gum Bottom Road and not have to cross the roadway from the time the contract begins until the roadway is formally closed. However, should construction traffic be crossing the roadway, traffic control devices need to be installed in accordance with the attached traffic control plan, Sheet C6.3. Flagmen shall be provided when equipment is crossing the roadway to minimize conflict between construction and public traffic.

**X.** As a result of this change, **replace** existing Sheet C 0.1, Recapitulation of quantities, with the revised Sheet C 0.1 including Maintenance of Traffic as a pay item.

**XI.** **Replace** the existing Section 902 Proposal Sheet with the attached Section 902 Proposal Sheet adding Maintenance of Traffic as a pay item.

**XII. Clarification – Earthwork Excavation**

Earthwork excavation will be performed in accordance with Section S-203, Excavation Embankment of the project specifications. **Quantities for Unclassified Excavation and other pay items are estimated. Final quantity will be made based upon field measurement. Special attention should be paid to Section S-203.09.2.3 of the specifications. This section requires that sod, vegetative materials and unsuitable soil shall be removed when the height of embankment to subgrade will be 3-foot or less. However, this removed material may be used under Pay Item S-211-A, Topsoil for Slope Treatment.**

Submitted By:

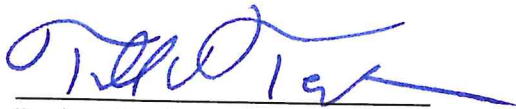

Project Engineer

Contractor

January 4, 2019  
Date

Date

**THIS ADDENDUM SHALL BE SIGNED, DATED AND SUBMITTED WITH BID DOCUMENTS.**

**FAILURE TO ACKNOWLEDGE RECEIPT OF THIS ADDENDUM AND ATTACH IT TO CONTRACT DOCUMENTS SHALL BE GROUNDS FOR REJECTING PROPOSAL.**

SITE GRADING AT MERIDIAN I-20/59 INDUSTRIAL PARK

I (We) agree to complete the entire project within 240 Calendar Days.

\*\*\*SPECIAL NOTICE TO BIDDERS\*\*\*

BIDS WILL NOT BE CONSIDERED UNLESS BOTH UNIT PRICES AND ITEM TOTALS ARE ENTERED

Ref. No.	Pay Item No.	Description	Approx. Quantity	Unit	Unit Price		Item Total
					Dollars	Cents	
<b>SITE GRADING ITEMS</b>							
1	S-200-A	MOBILIZATION	1.00	LS	XXXXXXXXXXXX	XXXXXXXXXXXX	
2	S-201-A	CLEARING AND GRUBBING	1.00	LS	XXXXXXXXXXXX	XXXXXXXXXXXX	
3	S-202-B	REMOVAL AND SALVAGE OF FIRE HYDRANT	2.000	EA			
4	S-202-D	REMOVAL OF PAVEMENTS (ALL TYPES) (ALL DEPTHS)	3,644.00	SY			
5	S-203-A	UNCLASSIFIED EXCAVATION (FM)	1,869,771.00	CY			
6	S-211-A	TOPSOIL FOR SLOPE TREATMENT (8 INCH DEPTH)	189,000.00	SY			
<b>EROSION CONTROL ITEMS</b>							
7	901-S-212-A	AGRICULTURAL LIMESTONE	542.00	TON			
8	S-212-A	COMMERCIAL FERTILIZER (13-13-13)	271.00	TON			
9	S-212-F	AMMONIUM NITRATE	41.00	TON			
10	S-214-A	SEEDING	271.00	ACRE			
11	S-215-A	VEGETATIVE MATERIALS FOR MULCH	542.00	TON			
12	S-229-A	PORTLAND CEMENT CONCRETE PAVED DITCH	72.00	CY			
13	S-233-A	TEMPORARY SILT FENCE (TYPE II)(AOS 0.15-0.84)	3,000.00	LF			
14	907-237-A	WATTLES, 20"	1,000.00	LF			
15	S-304-C	CRUSHED STONE (SIZE 24)(FOR CONSTRUCTION ENTRANC	200.00	TONS			
16	S-815-A	LOOSE RIPRAP, 100 LB	300.00	TON			
18	S-815-E	GEOTEXTILE UNDER RIPRAP/STONE (TYPE V)(AOS 0.21-0.4	500.00	SY			
18	901-S-236-A	DETENTION BASIN OUTLET STRUCTURE W/ SKIMMER	1.00	EA			
<b>TRAFFIC CONTROL ITEMS</b>							
19	S-618-A	MAINTENANCE OF TRAFFIC	1.000	LS	XXXXXXXXXXXX	XXXXXXXXXXXX	
20	S-618-B	ADDITIONAL CONSTRUCTION SIGNS	0.000	SF	10.00		
<b>UTILITY ITEMS</b>							
21	S-613-D	ADJUSTMENT OF SANITARY SEWER MANHOLE	3.00	EA			
22	S-613-D	ADJUSTMENT OF EXISTING FIRE HYDRANT	2.000	EA			
23	S-613-D	ADJUSTMENT OF EXISTING WATER VALVE	2.000	EA			
24	901-S-635-A	2" MDPE GAS SERVICE LINE, INSTALLED IN TRENCH	1,760.00	LF			
25	901-S-635-B	2" GAS VALVES	4.00	EA			
26	901-S-635-C	GAS LINE MARKER	4.00	EA			
27	901-S-635-D	TIE TO EXISTING NATURAL GAS LINE	2.00	EA			
							TOTAL BID



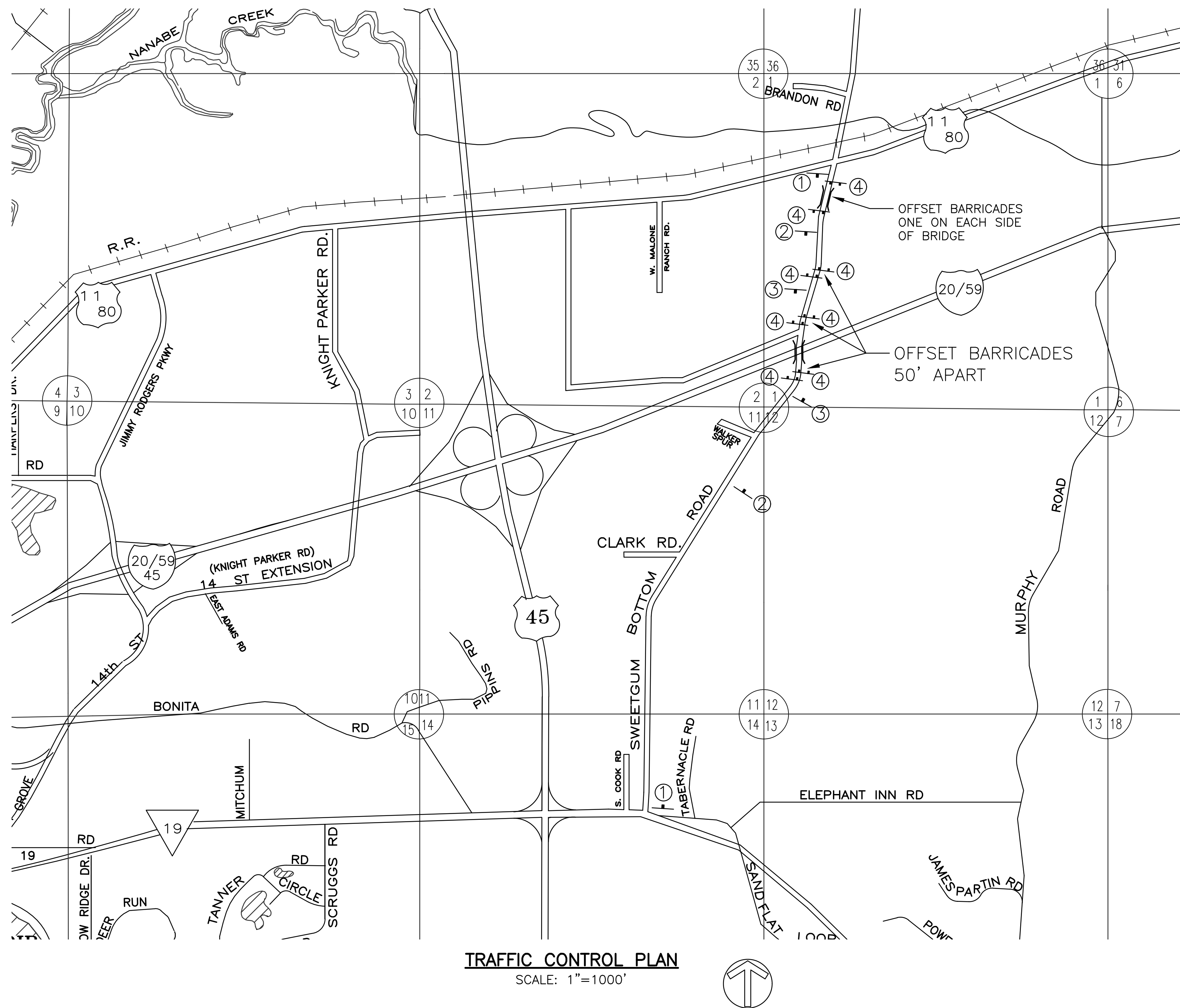

**TRAFFIC CONTROL PLAN**  
SCALE: 1"=1000'

**GENERAL NOTES:**

1. ALL SIGNS AND DEVICES SHALL CONFORM TO THE "MANUAL ON UNIFORM TRAFFIC CONTROL DEVICES", LATEST EDITION.
2. CONTRACTORS SHALL INSTALL TRAFFIC CONTROL DEVICES SUCH AS SIGNS, BARRICADES, CONES, DRUMS, LIGHTS, FLASHERS, AND PROVIDE FLAGGERS AS REQUIRED TO SAFEGUARD AND DIRECT TRAFFIC. (WHENEVER FLAGGERS ARE USED, INSTALL "FLAGGER AHEAD" SIGN EXCEPT DURING BRIEF PERIODS, OR EMERGENCY SITUATIONS.)
3. THE SIGNS AND DEVICES REQUIRED HEREON ARE A MINIMUM REQUIREMENT AND IT SHALL BE THE RESPONSIBILITY AND OBLIGATION OF THE CONTRACTOR TO DETERMINE AND PROVIDE ANY ADDITIONAL DEVICES REQUIRED TO SAFEGUARD THE PUBLIC.
4. TRAFFIC CONTROL DEVICES SHALL BE INSTALLED WHENEVER NECESSARY, REMAIN IN PLACE AS LONG AS THEY ARE NEEDED, AND BE REMOVED IMMEDIATELY WHEN THE NEED CEASES.
5. INSTALLATION OF SIGNS AND BARRICADES SHALL CONFORM TO STANDARD DRAWINGS 6358 AND SA-TSP-1.
6. PAY FOR INSTALLATION, MAINTENANCE AND REMOVAL OF TRAFFIC CONTROL DEVICES WILL BE MADE UNDER PAY ITEMS S-618-A AND S-618-B.
7. CONTRACTOR SHALL INSTALL ADVANCE WARNING SIGNS SUCH AS - WATCH FOR TRUCKS, TRUCKS TURNING, TRUCKS CROSSING, ETC. CONTRACTOR SHALL PROVIDE FLAGMEN AS NEEDED WHEN EQUIPMENT IS CROSSING THE ROAD TO MINIMIZE CONFLICT BETWEEN CONSTRUCTION AND PUBLIC TRAFFIC.
8. ALL SUPPLEMENTAL LETTERS TO BE BLACK-ON-ORANGE LEGEND AND A MINIMUM OF 4" HEIGHT.

SIGN SCHEDULE		
SIGN NO.	TYPE	DESCRIPTION
①	R11-3a	ROAD CLOSED AHEAD - LOCAL TRAFFIC ONLY
②	W20-1	ROAD WORK AHEAD 1000'
③	W20-1	ROAD WORK AHEAD 500'
④	TYPE III	BARRICADE (OFFSET 50' ALONG C)

ADDENDUM 4

**TRAFFIC CONTROL PLAN**  
120-59 INDUSTRIAL PARK  
LAUDERDALE COUNTY, MERIDIAN, MS

PREPARED FOR  
LAUDERDALE COUNTY BOARD OF SUPERVISORS  
MERIDIAN, MS

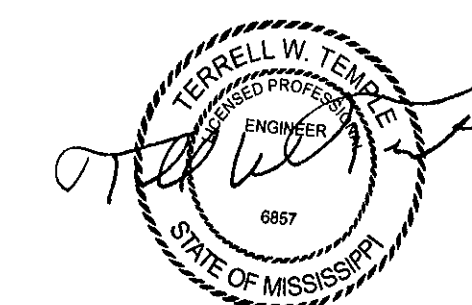

**Engineering Plus**

Planning • Surveying • Testing • Landscape Design  
1724-B 23rd Ave. Meridian, Mississippi 39301 (601) 693-4234

CIVIL3D/COUNTY/LC SITE DWG FILE: 2018/18-602_120-59/120-59 SITE DETAILS 1-4-19 ADDEND4 JOB NO. 18-602 DRAWING NO.	DATE: 01-04-19 DRAWN BY: LD CHECKED BY: SCALE:	SHEET <b>C6.3</b> OF
---	---	----------------------------